

# Northwestern University (McGraw Pavilion)

## Door, frame and hardware schedule

Hardware Set Number: 01  
 Frame Elevation: Type 2  
 Door Elevation: Type 1 & 2

Number of alike openings: 2

Opening #	Size	Opening Type	Hand	Area 1	To/From	Area 2	Fire Rating	Opening Degree
101	3' 0" x 7' 0"	Single	LH	Open Area	To	Office M338	None	90
102	3' 0" x 7' 0"	Single	RH	Open Area	To	Office M340	None	90

### Frame Information:

Material Type	Frame Material	Manufacture	Frame Depth	Gage	Anchors
Cold rolled steel	Hollow Metal	Mesker Door Inc.	5 3/4"	16	Steel stud

### Frame Notes or Concerns:

Glass for sidelite by others.

### Door Information

Material Type	Door Type	Manufacture	Thickness	Species/Gage	Core/Construction	Finish
Wood	Flush	Eggers Industries, Neenah	1-3/4"	Plain sliced white maple	PC5	Stain, custom color

### Door Notes or Concerns

### Hardware Information:

HardwareSet# 01

Quantity	Category	Manufacture	Product
3	Hinge	Design Hardware	BB5 4.5 x 4.5" x US26D x MS/WS
1	Cylindrical Lock	Schlage	ND70PD x ATH x 626 (Classroom)
1	Floor stop	Rockwood Manufacturing Co.	441CU x US26D (Low dome stop W / riser)
1	Coat hook	Rockwood Manufacturing Co.	806 x US26D
3	Accessory item	Rockwood Manufacturing Co.	608 Gray rubber silencer (metal frame)

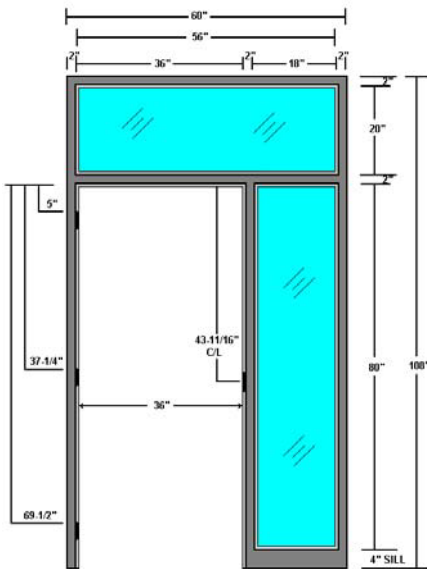

Type 2

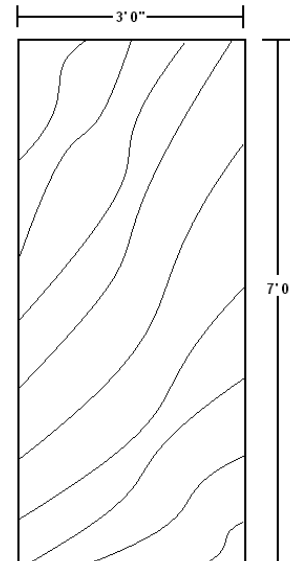
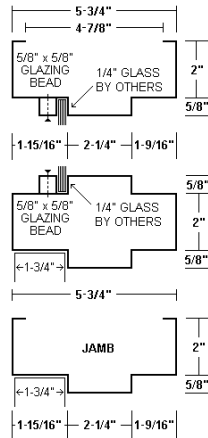

Type 1 & 2

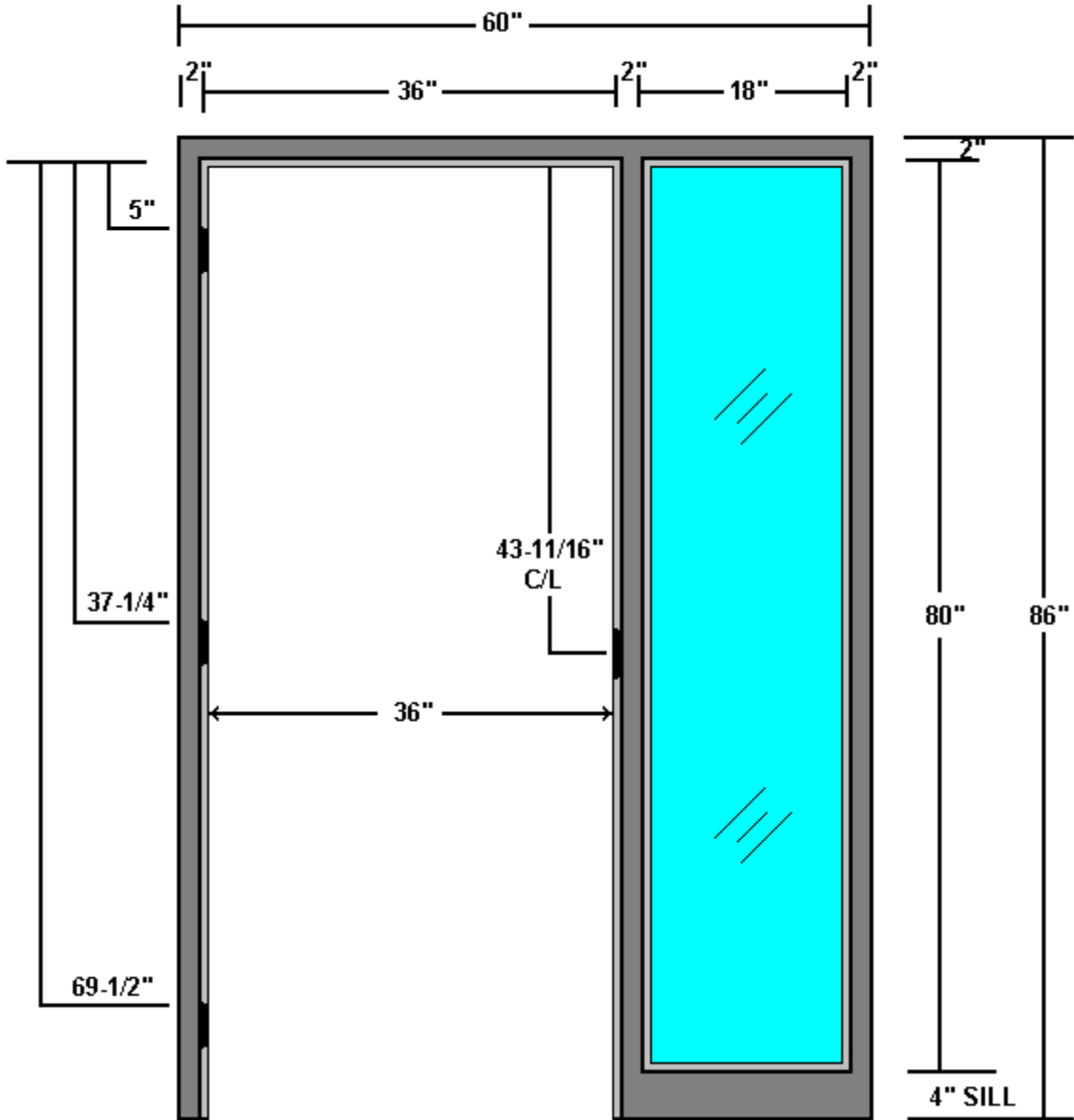

Hardware Set Number: 01  
 FrameElevation: Type 1  
 DoorElevation: Type 1 & 2

Number of alike openings: 1

Opening #	Size	Opening Type	Hand	Area 1	To/From	Area 2	Fire Rating	Opening Degree
103	3' 0" x 7' 0"	Single	LH	Open Area	To	Office M341	None	90

**Frame Information:**

Material Type	Frame Material	Manufacture	Frame Depth	Gage	Anchors
Cold rolled steel	Hollow Metal	Mesker Door Inc.	5 3/4"	16	Steel stud

**Frame Notes or Concerns:**

Glass for sidelite by others.

**Door Information**

Material Type	Door Type	Manufacture	Thickness	Species/Gage	Core/Construction	Finish
Wood	Flush	Eggers Industries, Neenah	1-3/4	Plain sliced white maple	PC5	Stain, custom color

**Door Notes or Concerns**

**Hardware Information:**

HardwareSet# 01

Quantity	Category	Manufacture	Product
3	Hinge	Design Hardware	BB5 4.5 x 4.5" x US26D x MS/WS
1	Cylindrical Lock	Schlage	ND70PD x ATH x 626 (Classroom)
1	Floor stop	Rockwood Manufacturing Co.	441CU x US26D (Low dome stop W / riser)
1	Coat hook	Rockwood Manufacturing Co.	806 x US26D
3	Accessory item	Rockwood Manufacturing Co.	608 Gray rubber silencer (metal frame)

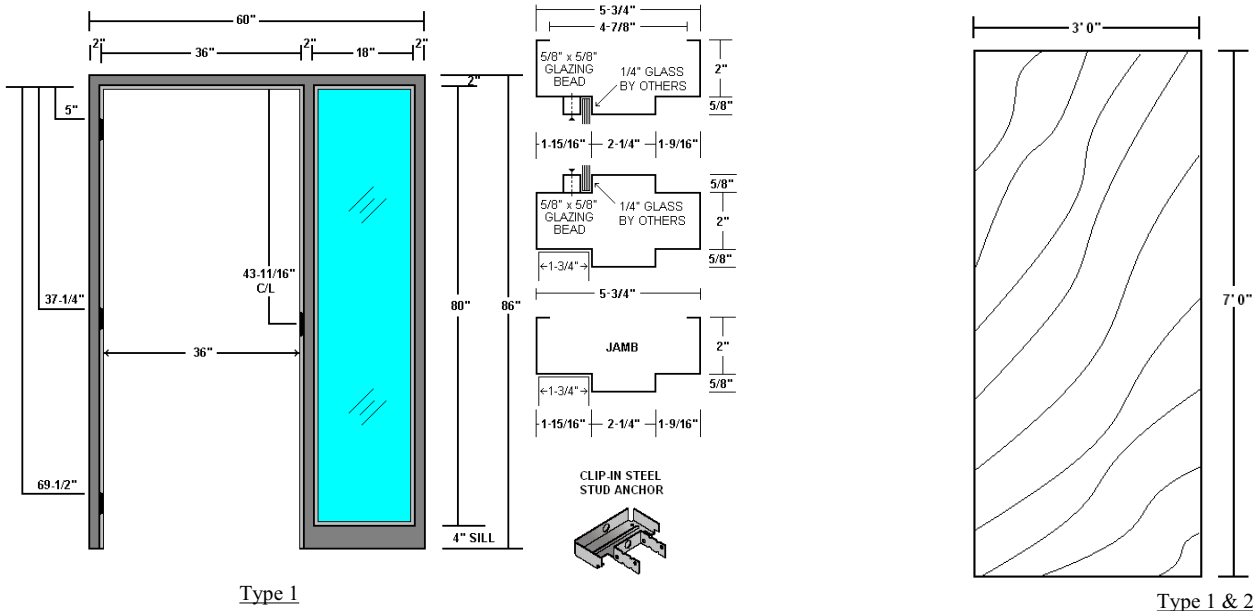

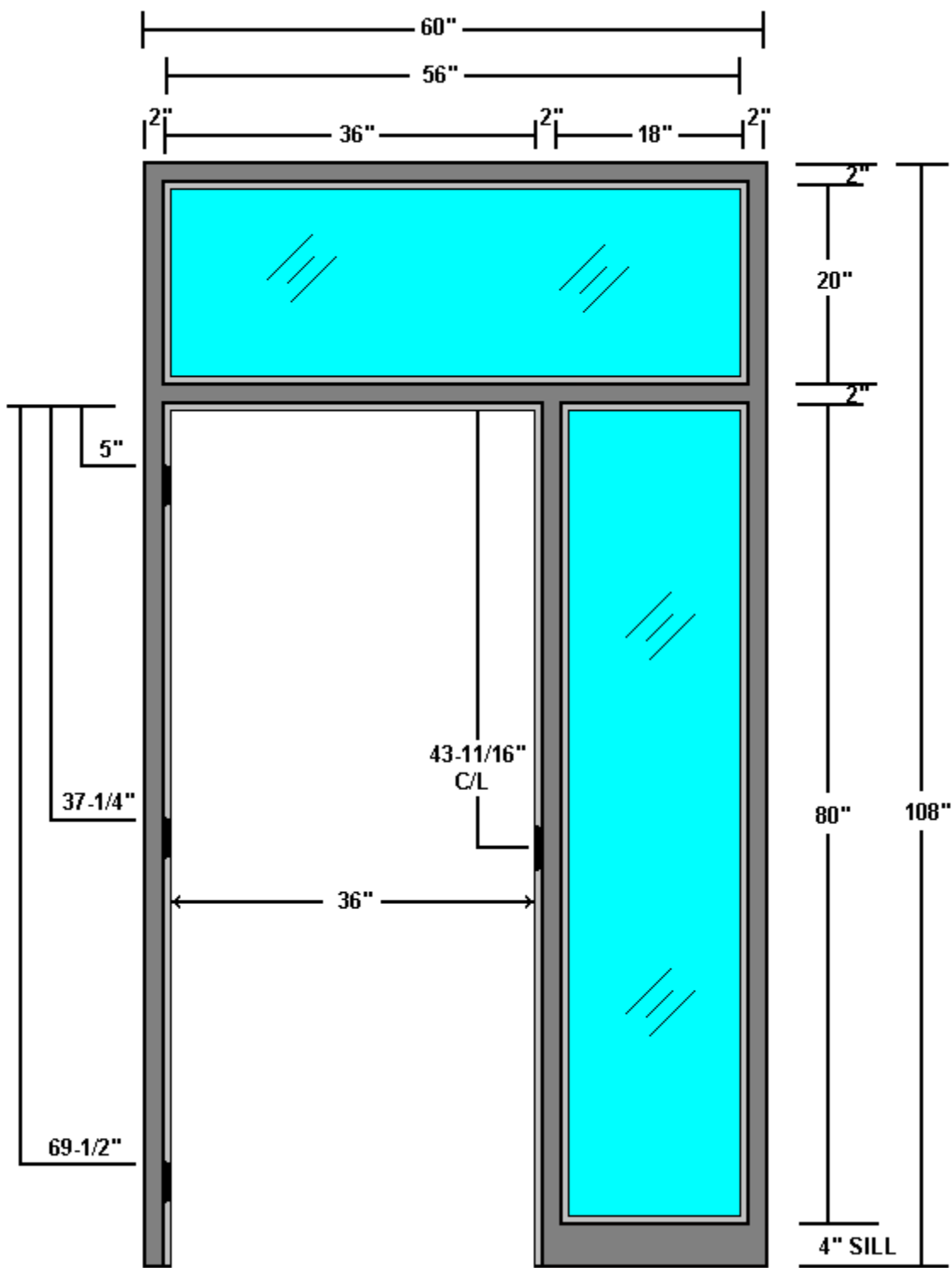

# Northwestern University (McGraw Pavilion)

## Door, frame and hardware schedule

Hardware Set Number: 02  
 Frame Elevation: Type 4  
 Door Elevation: Type 4

Number of alike openings: 2

Opening #	Size	Opening Type	Hand	Area 1	To/From	Area 2	Fire Rating	Opening Degree
105	3' 0" x 7' 0"	Single	LHR	Corridor	From	Conference M201A	None	90
105A	3' 0" x 7' 0"	Single	RHR	Corridor	From	Conference M201B	None	90

### Frame Information:

Material Type	Frame Material	Manufacture	Frame Depth	Gage	Anchors
Cold rolled steel	Hollow Metal	Mesker Door Inc.	5 3/4"	16	Steel stud

### Frame Notes or Concerns:

Frame prepped for electric strike.

### Door Information

Material Type	Door Type	Manufacture	Thickness	Species/Gage	Core/Construction	Finish
Wood	Full glass	Eggers Industries, Neenah	1-3/4"	Plain sliced white maple	SCL core	Stain, custom color

### Door Notes or Concerns

1/4" clear tempered glass provided.

### Hardware Information:

HardwareSet# 02

Quantity	Category	Manufacture	Product
3	Hinge	Design Hardware	BB5 4.5 x 4.5" x US26D x MS/WS
1	Cylindrical Lock	Schlage	ND80PD x ATH x 626 (Storeroom)
1	Electric Strike	HES, Inc.	5200 x 12/24VAC/VDC x 630 (Fail Safe/Secure)
1	Surface Closer	LCN	4111 x EDA x 689 (Alum) x TBSRT
1	Floor stop	Rockwood Manufacturing Co.	441CU x US26D (Low dome stop W / riser)
1	Electrical accessory	HES, Inc.	2005 Smartpac II (In-line power control / timer)
1	Electrical accessory	HES, Inc.	501 x 630 (Face plate for metal frame)
3	Accessory item	Rockwood Manufacturing Co.	608 Gray rubber silencer (metal frame)

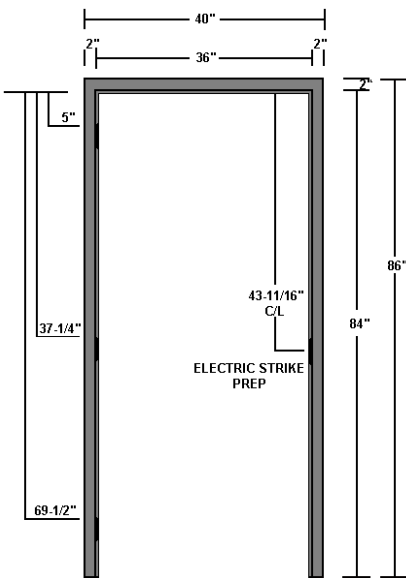

Type 4

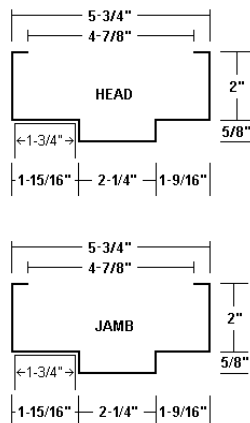

CLIP-IN STEEL STUD ANCHOR

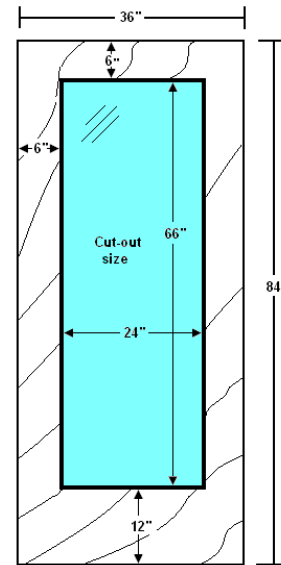
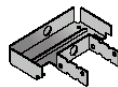

Type 4

Hardware Set Number: 02

Number of alike openings: 1

FrameElevation: Type 3

DoorElevation: Type 3

Opening #	Size	Opening Type	Hand	Area 1	To/From	Area 2	Fire Rating	Opening Degree
104	3' 0" x 7' 0"	Single	RH	Corridor	To	Break Room M348	None	90

**Frame Information:**

Material Type	Frame Material	Manufacture	Frame Depth	Gage	Anchors
Cold rolled steel	Hollow Metal	Existing to remain	N/A	N/A	N/A

Frame Notes or Concerns:

**Door Information**

Material Type	Door Type	Manufacture	Thickness	Species/Gage	Core/Construction	Finish
			1-3/4			

Door Notes or Concerns

Existing door to be reused.

**Hardware Information:**

HardwareSet# 02

Quantity	Category	Manufacture	Product
3	Hinge	Design Hardware	BB5 4.5 x 4.5" x US26D x MS/WS
1	Cylindrical Lock	Schlage	ND80PD x ATH x 626 (Storeroom)
1	Electric Strike	HES, Inc.	5200 x 12/24VAC/VDC x 630 (Fail Safe/Secure)
1	Surface Closer	LCN	4111 x EDA x 689 (Alum) x TBSRT
1	Floor stop	Rockwood Manufacturing Co.	441CU x US26D (Low dome stop W / riser)
1	Electrical accessory	HES, Inc.	2005 Smartpac II (In-line power control / timer)
1	Electrical accessory	HES, Inc.	501 x 630 (Face plate for metal frame)
3	Accessory item	Rockwood Manufacturing Co.	608 Gray rubber silencer (metal frame)

**Existing frame  
to remain**

**No profile**

**Existing door  
to remain**

Type 3

Type 3

# Hardware set review

## Hardware Set #

01

Quantity	Category	Manufacture	Product
3	Hinge	Design Hardware	BB5 4.5 x 4.5" x US26D x MS/WS
1	Cylindrical Lock	Schlage	ND70PD x ATH x 626 (Classroom)
1	Floor stop	Rockwood Manufacturing Co.	441CU x US26D (Low dome stop W / riser)
1	Coat hook	Rockwood Manufacturing Co.	806 x US26D
3	Accessory item	Rockwood Manufacturing Co.	608 Gray rubber silencer (metal frame)

## Hardware Set #

02

Quantity	Category	Manufacture	Product
3	Hinge	Design Hardware	BB5 4.5 x 4.5" x US26D x MS/WS
1	Cylindrical Lock	Schlage	ND80PD x ATH x 626 (Storeroom)
1	Electric Strike	HES, Inc.	5200 x 12/24VAC/VDC x 630 (Fail Safe/Secure)
1	Surface Closer	LCN	4111 x EDA x 689 (Alum) x TBSRT
1	Floor stop	Rockwood Manufacturing Co.	441CU x US26D (Low dome stop W / riser)
1	Electrical accessory	HES, Inc.	2005 Smartpac II (In-line power control / timer)
1	Electrical accessory	HES, Inc.	501 x 630 (Face plate for metal frame)
3	Accessory item	Rockwood Manufacturing Co.	608 Gray rubber silencer (metal frame)

## Hardware Set #

02.1

Quantity	Category	Manufacture	Product
3	Hinge	Design Hardware	BB5 4.5 x 4.5" x US26D x MS/WS
1	Cylindrical Lock	Schlage	ND80PD x ATH x 626 (Storeroom)
1	Electric Strike	HES, Inc.	5200 x 12/24VAC/VDC x 630 (Fail Safe/Secure)
1	Surface Closer	LCN	4011 x REG x 689 (Alum) x TBSRT
1	Floor stop	Rockwood Manufacturing Co.	441CU x US26D (Low dome stop W / riser)
1	Electrical accessory	HES, Inc.	501 x 630 (Face plate for metal frame)
1	Electrical accessory	HES, Inc.	2005 Smartpac II (In-line power control / timer)
3	Accessory item	Rockwood Manufacturing Co.	608 Gray rubber silencer (metal frame)